



# *westshore* DEVELOPMENT FORUM



Where *workplace* is  
tailored to your *success*.

*Our mission is to create the most  
compelling and supportive workplaces  
for your talent to thrive.*



# HIGHWOODS *expansion*

Highwoods has entered the Dallas market through the formation of joint ventures with Granite Properties.

## 23 Springs

- Mixed-use development
- 626,000 square feet
- multi-customer office and 16,000 square feet of retail

- Uptown Dallas BBD

## Granite Park Six

- Multi-customer office development
- 422,000 square feet
- Multi-customer office development
- Frisco/Plano BBD

Highwoods owns a 50% interest in each of the joint ventures.



# MIDTOWN *tampa*

- 23 acres, 1.8M SF
- 700K SF office
- 185K SF retail
- 390 residential units
- 230 hotel rooms
- 3-acre lake and walking trail



# MIDTOWN *west*

- 152K SF office, 8 floors
- 22K SF typical floorplate
- Dual Lobbies
- Structured parking with covered walkway
- 87% leased

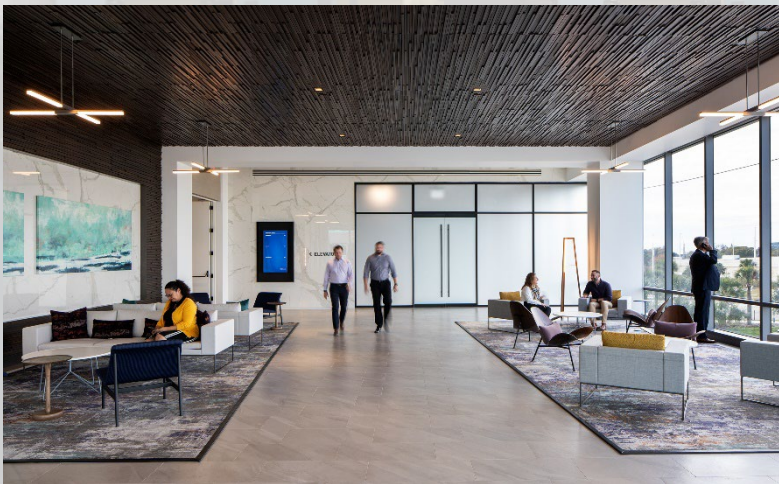

# MIDTOWN *east*

- ~400K SF
- 26K SF typical floorplate
- Covered terraces with certain suites
- Smart energy management systems
- LEED, Fitwel, and Wired certifications to be pursued
- Retail and restaurant space on ground level



# HIGHWOODS' WESTSHORE *portfolio*

Avion	174K SF
Highwoods Bay Center	209K SF
Independence One	116K SF
Meridian One, Two, Three	592K SF
Midtown West	150K SF
Tampa Bay Park (7 buildings)	1.1M SF
Tower Place	180K SF
Westshore Square	57K SF
<b>Total RSF - Westshore</b>	<b>2.5M SF</b>



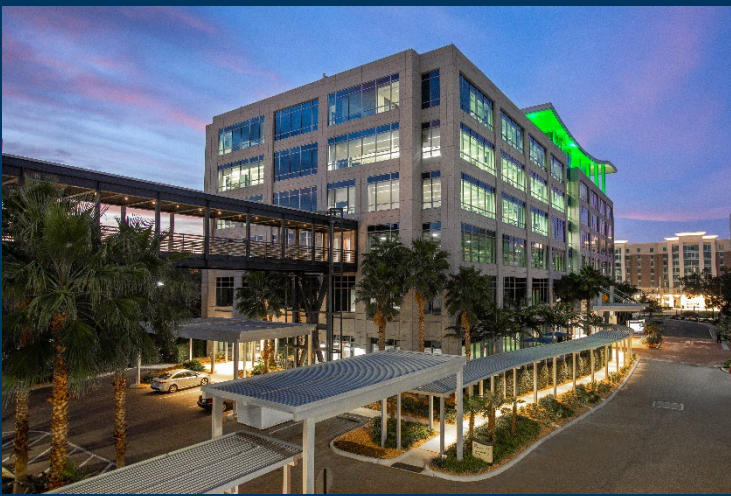

Avion



LakePointe One & Two



Tower Place



Midtown West



Highwoods Bay Center



Meridian



# *westshore* DEVELOPMENT FORUM



WE'RE IN THE  
*work-placemaking*  
BUSINESS

CREATING ENVIRONMENTS THAT SPARK EXPERIENCES  
WHERE THE BEST AND BRIGHTEST CAN ACHIEVE TOGETHER  
WHAT THEY CANNOT APART.