



Airside D Project Update

Smitha Radhakrishnan, Chief Development Officer



Hillsborough County Aviation Authority
Tampa International, Peter O. Knight,
Plant City and Tampa Executive Airports



PASSENGER TRAFFIC

Tampa International Airport is projected to serve 25,912,550 passengers in FY25



Passenger Growth Forecast: Nearly 39 million by 242

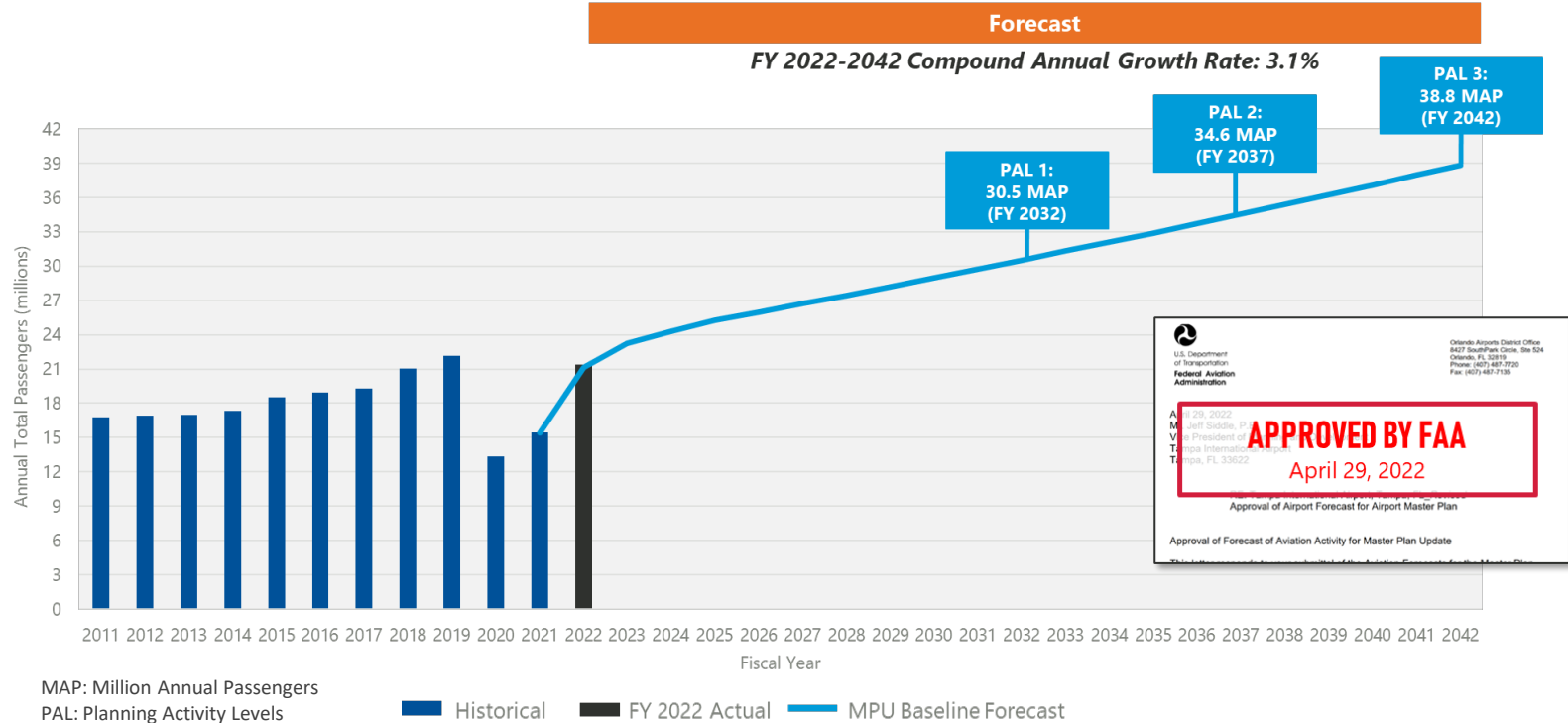



Tampa
International
Airport

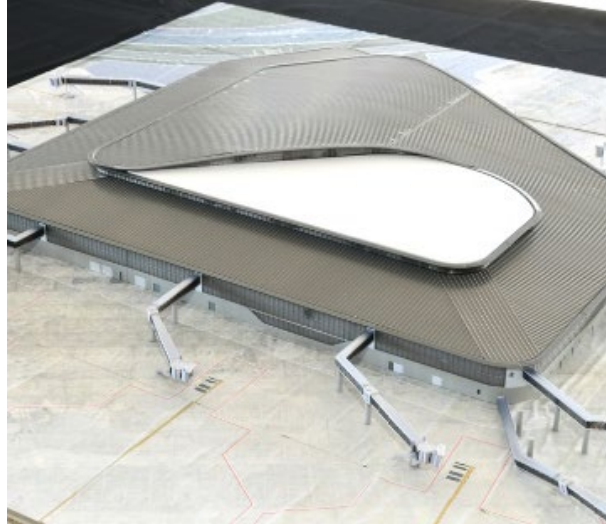



Airside D



- 1st new Airside at TPA in nearly 20 years
- 2-Level Airside, plus a mezzanine
- Two airline lounges
- International Passenger Arrival Processing Facilities
- New shopping and dining locations
- Will help TPA serve up to 35 million annual passengers by 2037

Airside C: Approx. 320,000 sq. ft.
Airside D: Approx. 615,000 sq. ft.



Overview

Club Mezzanine

Departures Level

Apron Level

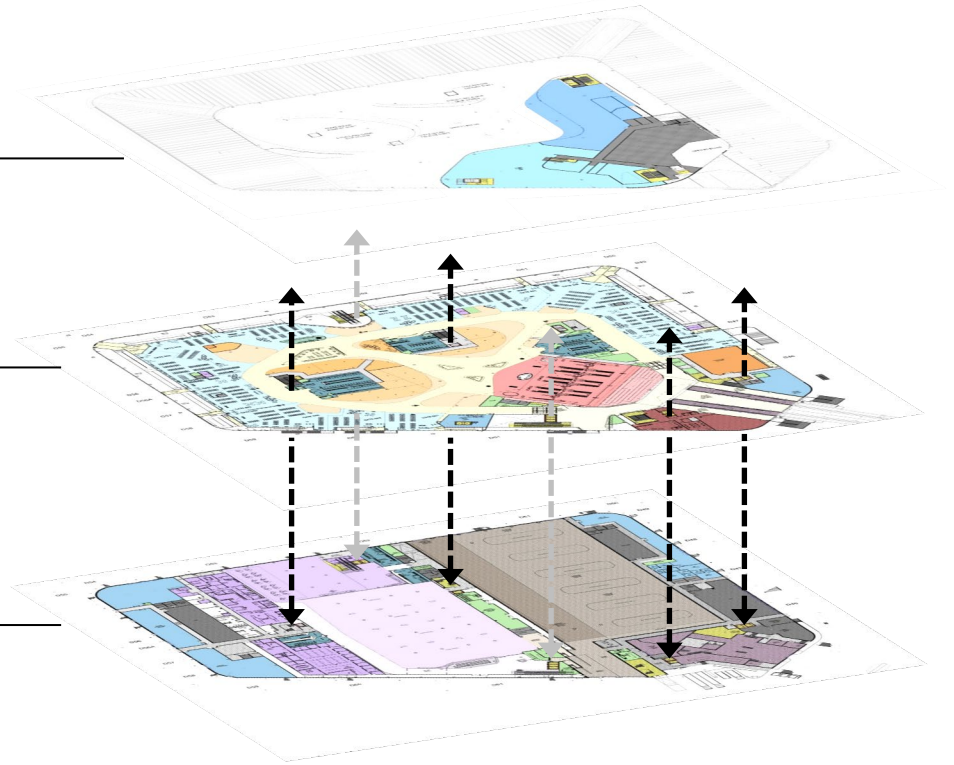

Departure Level

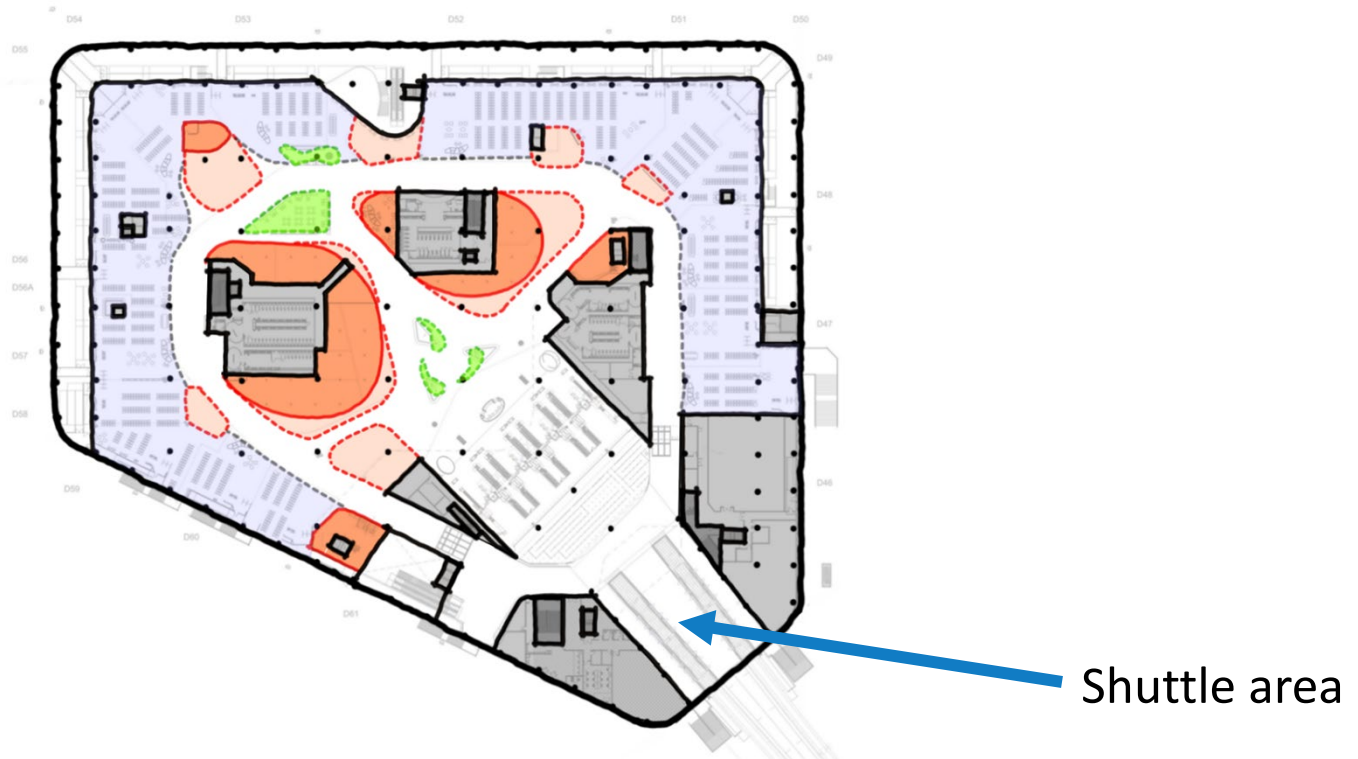

Departure Level

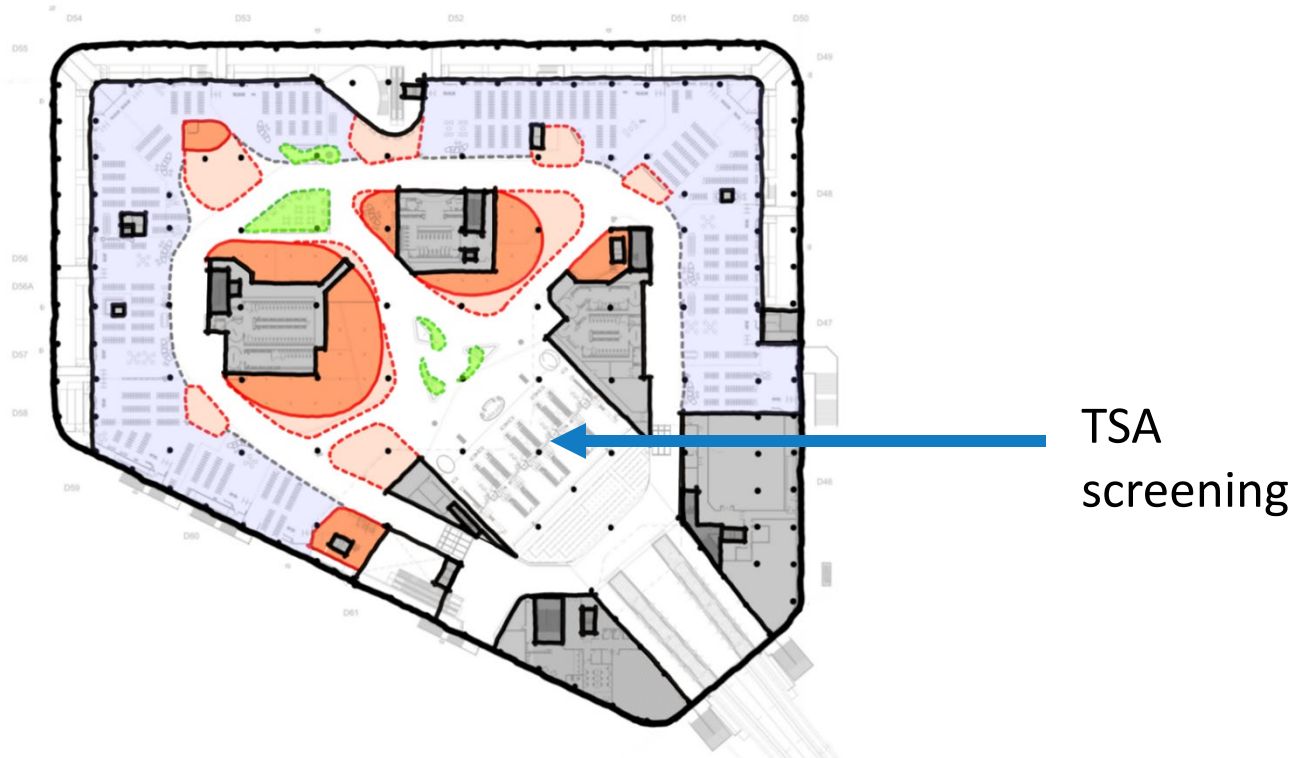

Departure Level

Dining and
retail

Dining and
retail

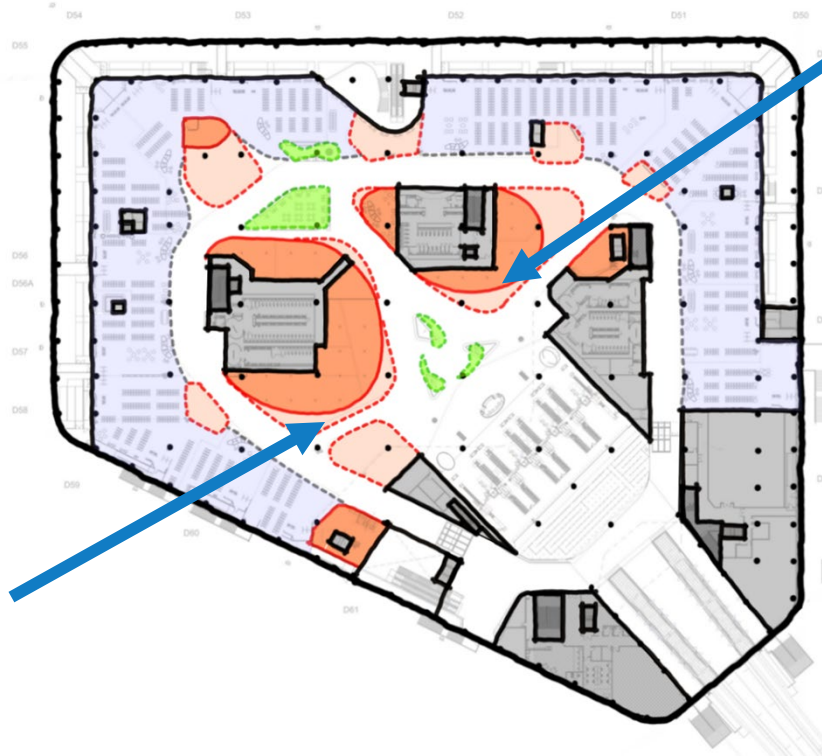

Departure Level

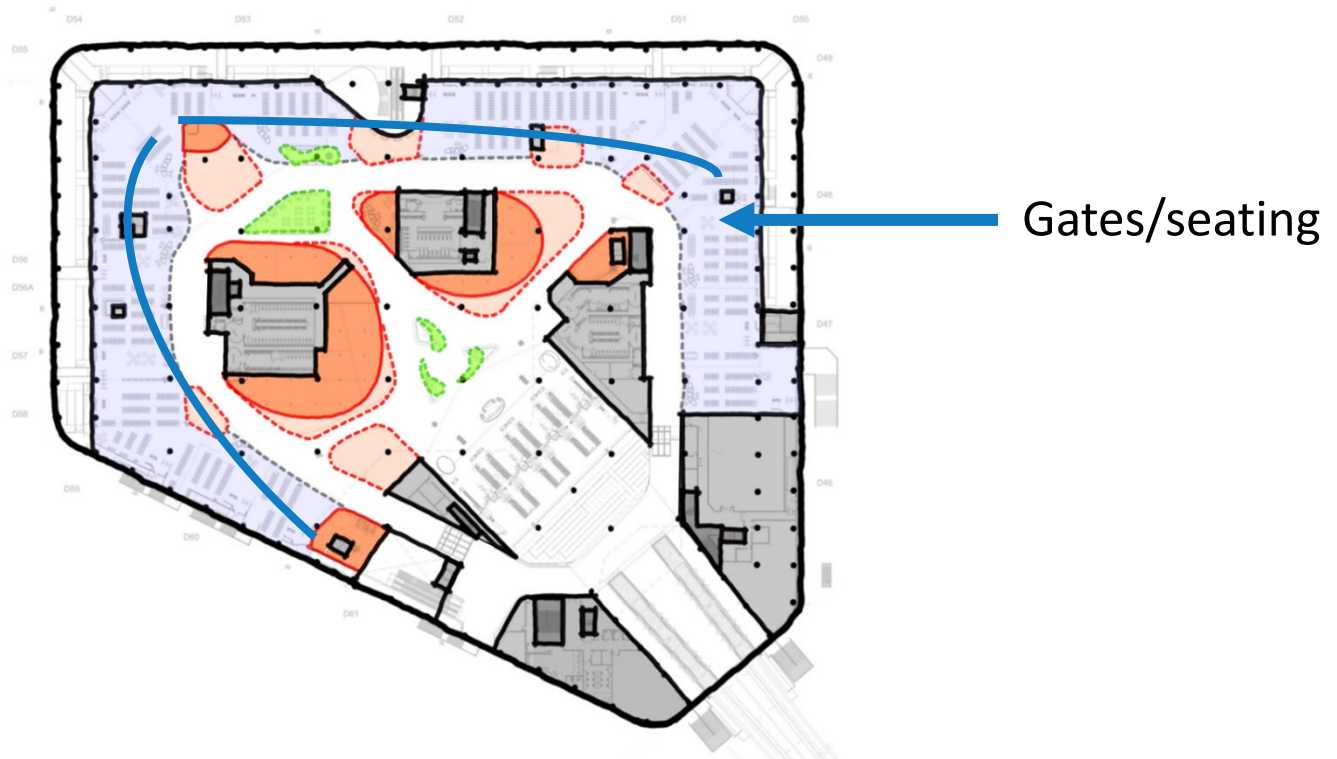

Departure Level

International
arrivals corridor

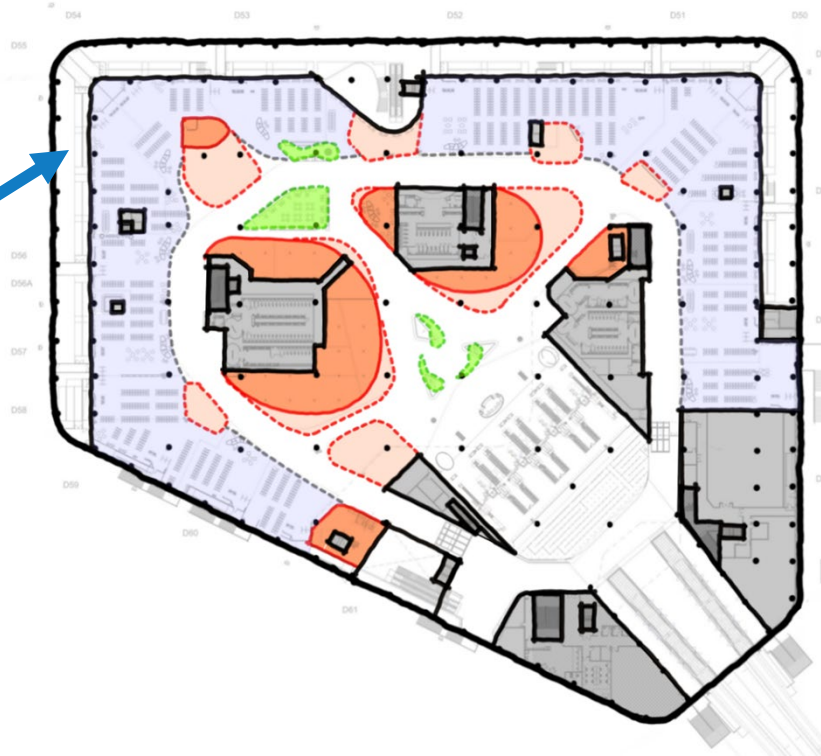

Post Security



International Arrivals





Construction Site





LEARN ABOUT

TPA SOLICITATION OPPORTUNITIES

Scan code for the e-Procurement Portal







Hillsborough County Aviation Authority
Tampa International, Peter O. Knight,
Plant City and Tampa Executive Airports

Question and Answer Session

Other Project Updates

Airsides A & E Security Screening Checkpoint Expansions



Airside E – 20,000 SF Expansion



Airside A – 20,000 SF Expansion



Hillsborough County Aviation Authority
Tampa International, Peter O. Knight,
Plant City and Tampa Executive Airports

Red Side Express Lanes

Curb Expansion Program

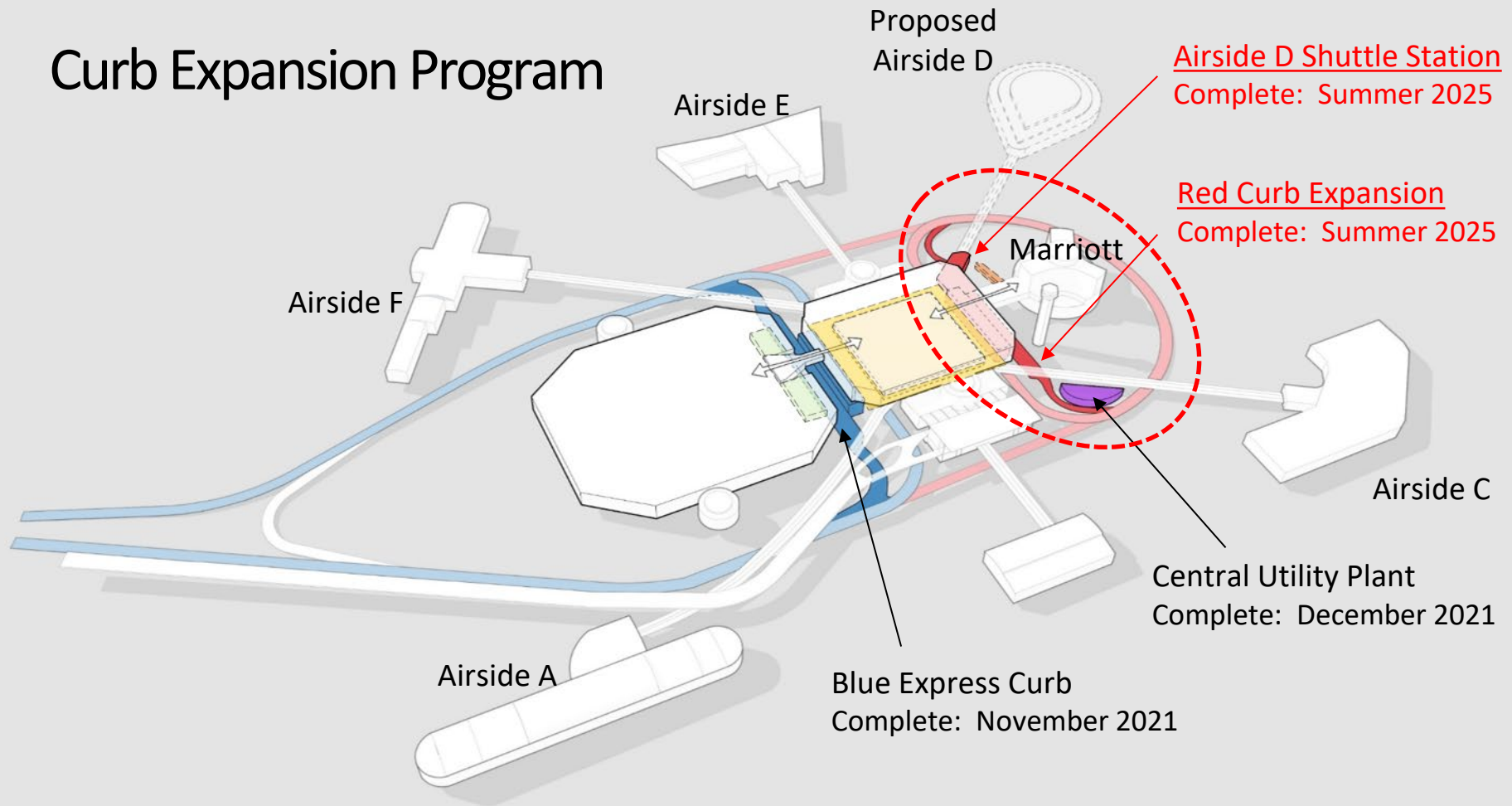

Red Side Express Lanes

Open this fall

First-in-the-U.S. amenity

Faster pick-up and drop-off

Uber and Lyft location





Hillsborough County Aviation Authority
Tampa International, Peter O. Knight,
Plant City and Tampa Executive Airports

New Airside A & C Shuttle Cars

New Airside A & C Shuttle Cars

- Shuttle Car delivery (April, June, and Oct.)
- New Blue Cars Operational: Oct. 2025
- New Red Cars Operational: Dec. 2025
- Project Complete: December 2025



